



वृक्षावन Apartment

— 3 BHK Luxurious Flat —

A Project By: Delta Developers



We welcome you to create
memories of your own!



Delta Developers with its trailing legacy of myriad landmark projects has become a synonym of quality and trust. We are dedicated to the art of engineering projects with epitome standard of quality and we proudly boast of having a track record of delivering them on time.

We don't add customers. We add family members.
We warmly welcome you to be a part of Delta family!

Close to Everything

Site Address: Plot No. 292/293, Laxmi Nagar, WHC Road, Nagpur-440022

- 100 Mt. Daily Needs
- 200 Mt. Hospital
- 500 Mt. School / College
- 1.0 KM Petrol Pump



A lifestyle
designed for
**comfort,
Convenience,
& healthy living!**

It is the residents that add beauty to every design we create that enhances the living standards of our values buyers. It ranges from vast open spaces that feel aloof from the city life to the commercial space that adds a tinge of convenience.



UNWIND IN *Serenity*



Beauty is much
more than what
meets an eye



LIVE WITH *Comfort*



We create spaces that make small yet **beautiful memories** and moments which together become big to create a **masterpiece called life**



Terrace Garden with Gazebo



Children's Play Area



Viewing Deck in Terrace



Senior Citizen Area

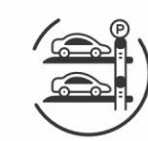

Mechanicals Parking



Lavish Entrance Lobby



EV Charging Point



Security Guard



Power Backup With DG Set Common Area



POP in All Rooms



Video Door Phone



Solar For Common Area



Walking & Jogging Track



GYM & Yoga Indoor



Gazebo Lounge



Open Reading Space at Terrace



High Speed Automatic Lifts



CCTV / Security in common area



Ground Floor Plan



VRUNDAVAN
- Every Moment is a Fresh Beginning
Project By:
DELTA DEVELOPER

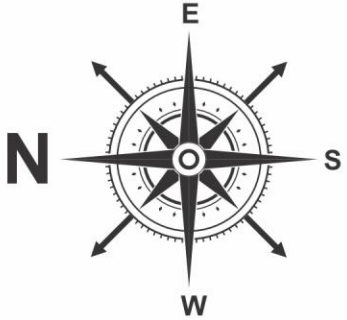

Ground Floor Plan

Typical Floor Plan





A serene way of *Living*

Isometric View

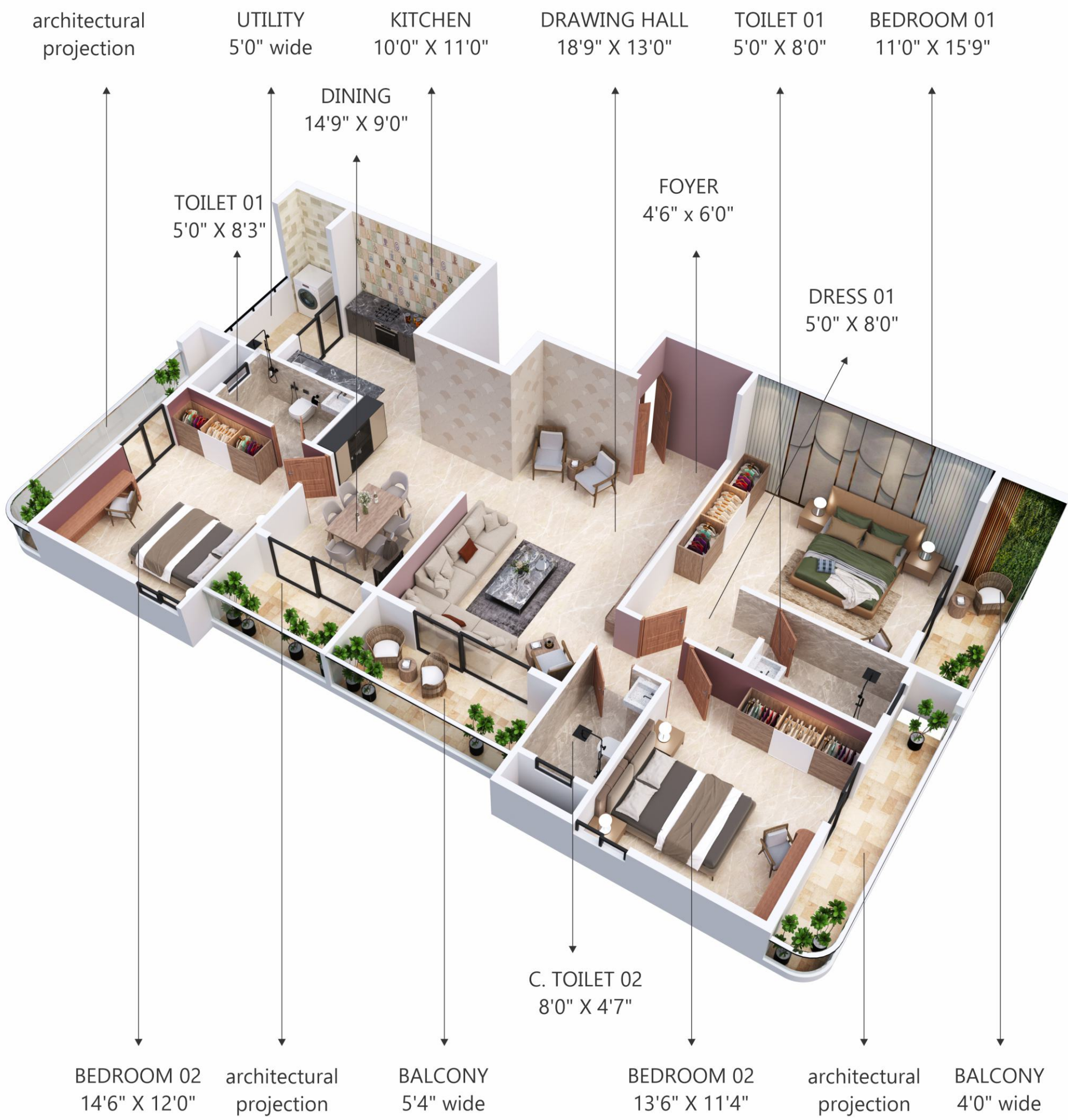

Isometric View

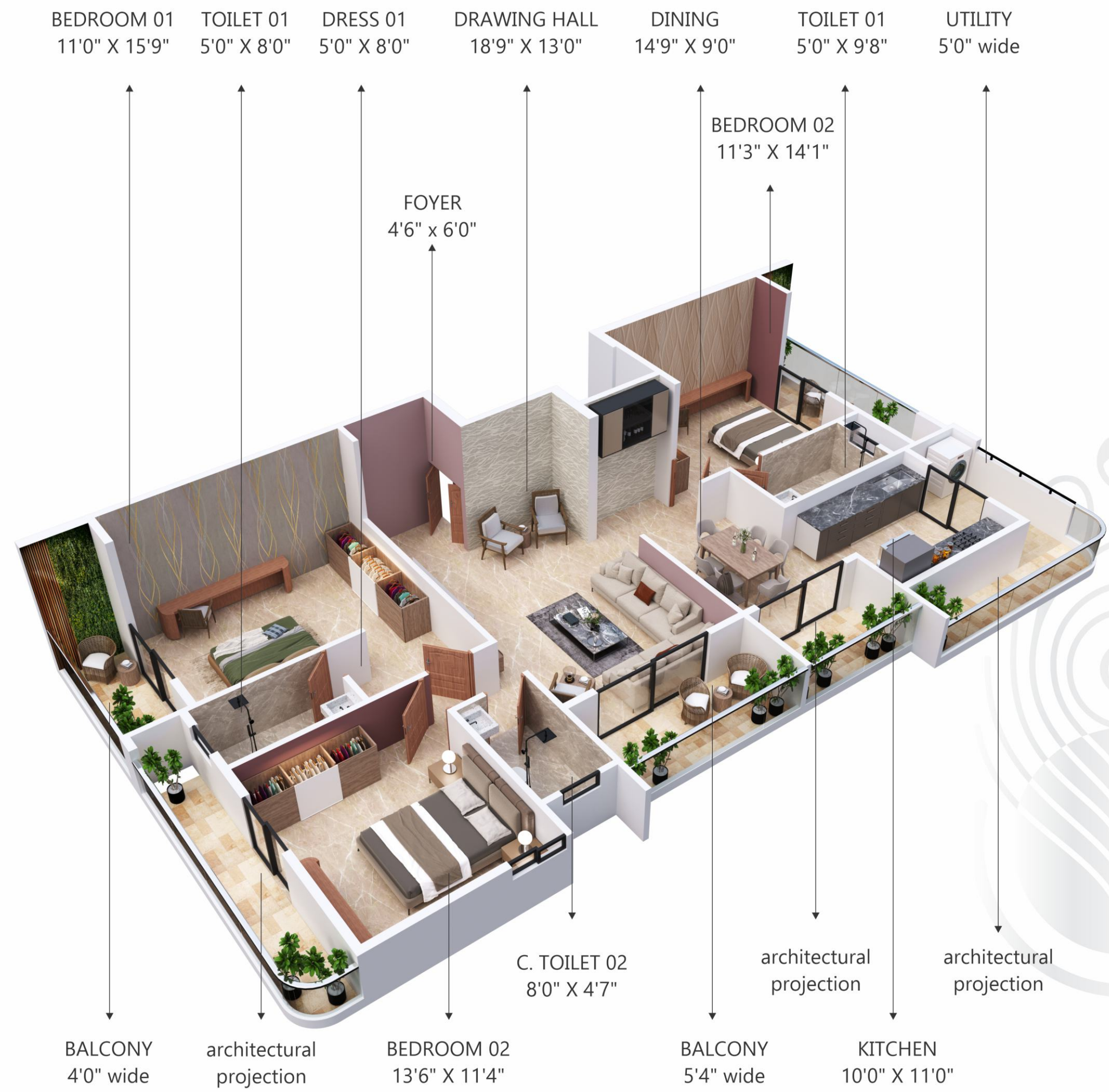



Terrace Floor Plan

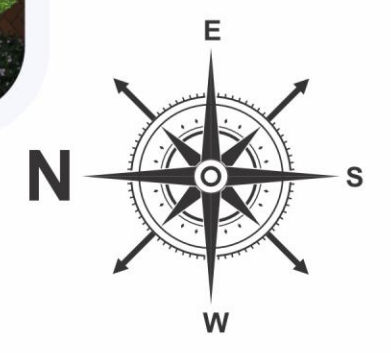



Evergreen surroundings, scenic views as far as your eyes can see, and the absolutely unparalleled and coveted location that is Laxminagar. These are just some of the things that make residential suites at Vrundavan Apartment an absolute joy to behold. This is a realm in which every single window opens to a breathtaking view of the Sahyadris, as whispering winds serenade and swirl through your very abode no less. Surrounded by an ocean of greens and girdled by endless vistas of flora and fauna, Vrundavan Apartment is not only meant to be your home, but of mother nature as well.



We don't believe in just building spaces, we believe in creating **SPACES THAT CREATE MEMORIES**



LIVE WITH *Elegance*

Specification



STRUCTURE

- Earth-quake resistant, RCC framed structure



PLUMBING

- ISI Mark Full CPVC, UPVC, SWR Pipe Fittings
- PVC Pipe for Soil pipe & Rain Water pipe
- Rain Water Harvesting



WALLS

- Internal : 4" (115mm) thick brick
- External : 6" (150mm) thick brick



DOORS & WINDOWS

- Main Door - Veneer finish Door
- Other Door - Plywood Frame & Mica finish Door



BED ROOM & LIVING ROOM

- Designer Floor Tiles
- Cable TV connections in All Room
- AC Point Hall & Bedrooms
- POP All Rooms



WINDOWS

- UPVC Window with Mosquito Jali
- Glass Railing in Balcony & Terrace
- SS Railing in Staircase



KITCHEN

- Granite top with S.S. Sink, Aqua guard point



BATHROOM

- Matt Finish floor (2'X2')
- Washbasin
- Premium make fittings & premium sanitary ware
- Designer dado up to 8'
- Hot & Cold water connection
- PVC Ceiling in Balcony & Bathroom



PAINTING

- Internal - Emulation Paint with Full Putty
- External - Weather proof Paint



LIFT & PARKING

- LIFT With ARD, Generator Backup
- Allotted Car Parking
- Automatic water controller
- Designer Lobby at All Floors



ELECTRICAL

- Concealed electrical fitting with ISI Wire and modular switches
- Sufficient power outlet and light points provided

Note:- Stamp Duty & Registration fees | Electrical Meter charges, Air Conditioning, Transformer deposit, Water Meter & Connection Charges. Deposits & Expenses at actual to be paid extra in advance. G.S.T. or any such additional taxes will be charged extra. Changes in the specification & plan will cost extra. Possession of the Shop/office will be given by the builder after clearance of all dues. Any Extra Work shall be charged separately before execution.

A Project By



www.deltadevelopers.in

E-mail: deltadevelopers471@gmail.com

+91 9823270471, 9423100471

Office Address: Plot No. 54/B, Shri Tower,
Near Sai Vatika Lawn, Shankar Nagar, Nagpur-10

 Architect
PRATIBHA DESIGNERS
Ar. Hemant Mandwekar
+91-9764003090

 **INDIA 3D** 9975750596

NOTES: This Project Brochure is for restricted private circulation only and shall neither be considered as a legal document or binding agreement with obligation for specific performance nor as an offer for sale in any case. The Project Vendor and Land Owners, at their sole discretion, have reserved all rights to change or revise or make any modification, alteration omission, addition in the Project as a whole or any part thereof or any details therein without any notice to anybody as and when required of necessary for any reason and the same will be binding to all the concerned whether it may or may not affect their respective interests or rights whatsoever in the Project. All outer & interior architectural 3D images, appearance of the buildings including its elements, roads, floor paving, plants, surroundings, colors etc. shown in this Brochure are not factual or real view but merely conceptual presentation using computer graphics meant for tentative and easy understanding of the Project, its features and elements in general. All dimensions, measurements and sizes shown in this Brochure are approximate and are from the unfinished surface which may differ or vary when finished finally.